

ADDENDUM NUMBER: Two

PROJECT: Craven County Government Center East
Havelock, North Carolina

PROJECT NO 25012

DATE: June 23, 2026

OWNER: Craven County
406 Craven Street, New Bern, North Carolina

ARCHITECT: Oakley Collier Architects, P.A.
109 Candlewood Road
Rocky Mount, North Carolina 27804
(252) 937-2500

PREVIOUSLY ISSUED: One

TO ALL CONTRACTORS:

This Addendum is hereby made a part of the Contract Documents to the same extent as if initially included. This Addendum must be acknowledged in the Form of Proposal and shall be included in the Contract Documents.

Drawings and Project Manual dated **May 30, 2026**, for this project are hereby modified, corrected, or supplemented as follows:

General

Revision: Civil Drawings
See the attached Civil Drawings. Civil Sheets C-1, C-2, C-3, C-4, C-5, C-6, C-7, CES-1, L-1, LSP-1, D-1, and D-2 shall be included in their entirety with the previously issued bid plans and specifications.

End of Addendum

CONSTRUCTION DRAWINGS
 GOVERNMENT CENTER
 EAST – HAVELOCK
 1208 E. MAIN ST., HAVELOCK, NC
 CRAVEN COUNTY
 NORTH CAROLINA

JUNE 2026

INDEX OF SHEETS	
SHEET #	SHEET TITLE
C-1	COVER
C-2	LEGEND
C-3	GENERAL NOTES
C-4	EXISTING CONDITIONS
C-5	DEMOLITION PLAN
C-6	SITE AND UTILITY PLAN
C-7	GRADING PLAN
CES-1	EROSION AND SEDIMENT CONTROL PLAN
L-1	LIGHTING PLAN
LSP-1	LANDSCAPING PLAN
D-1 THRU D-2	CONSTRUCTION DETAILS

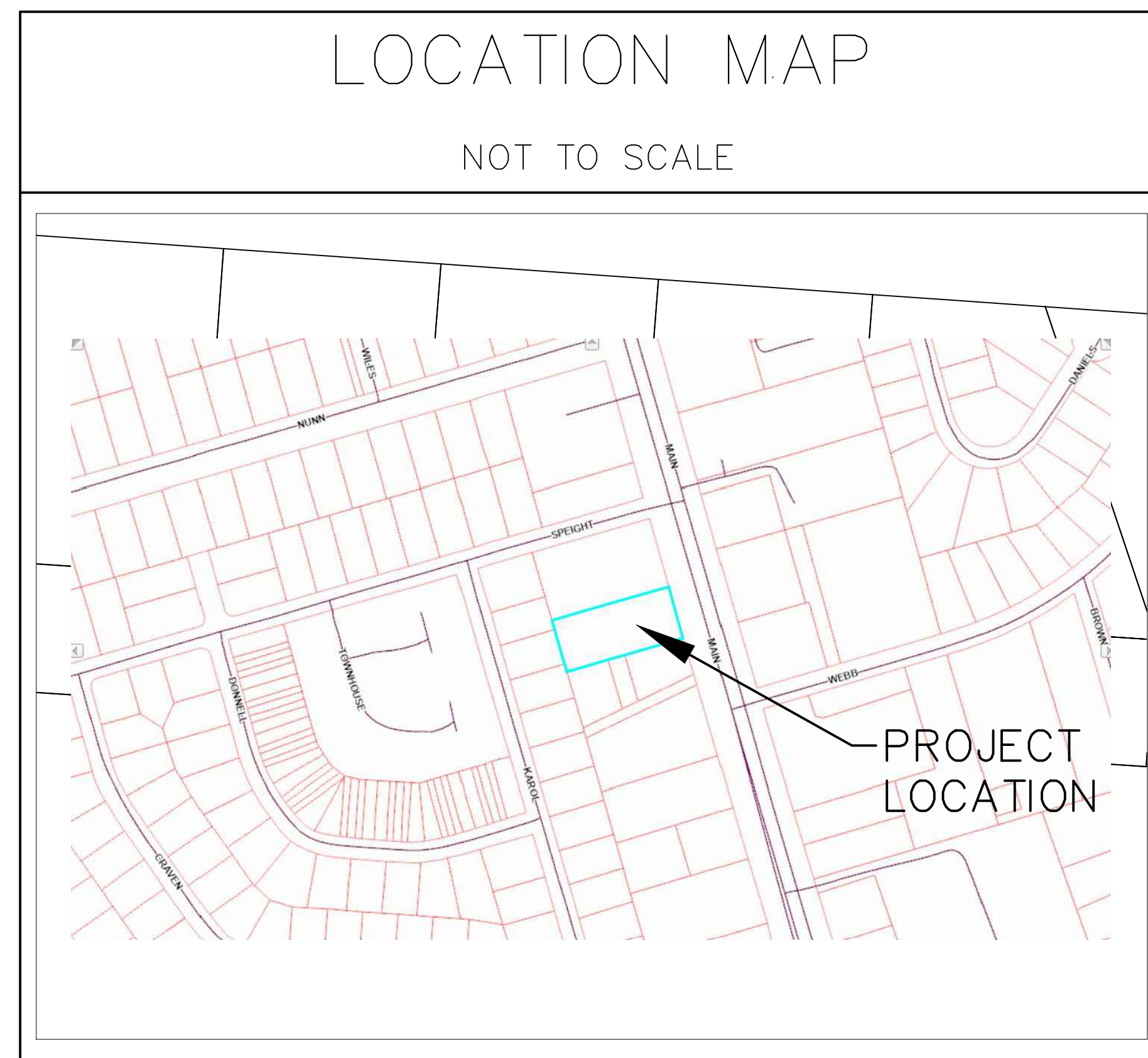
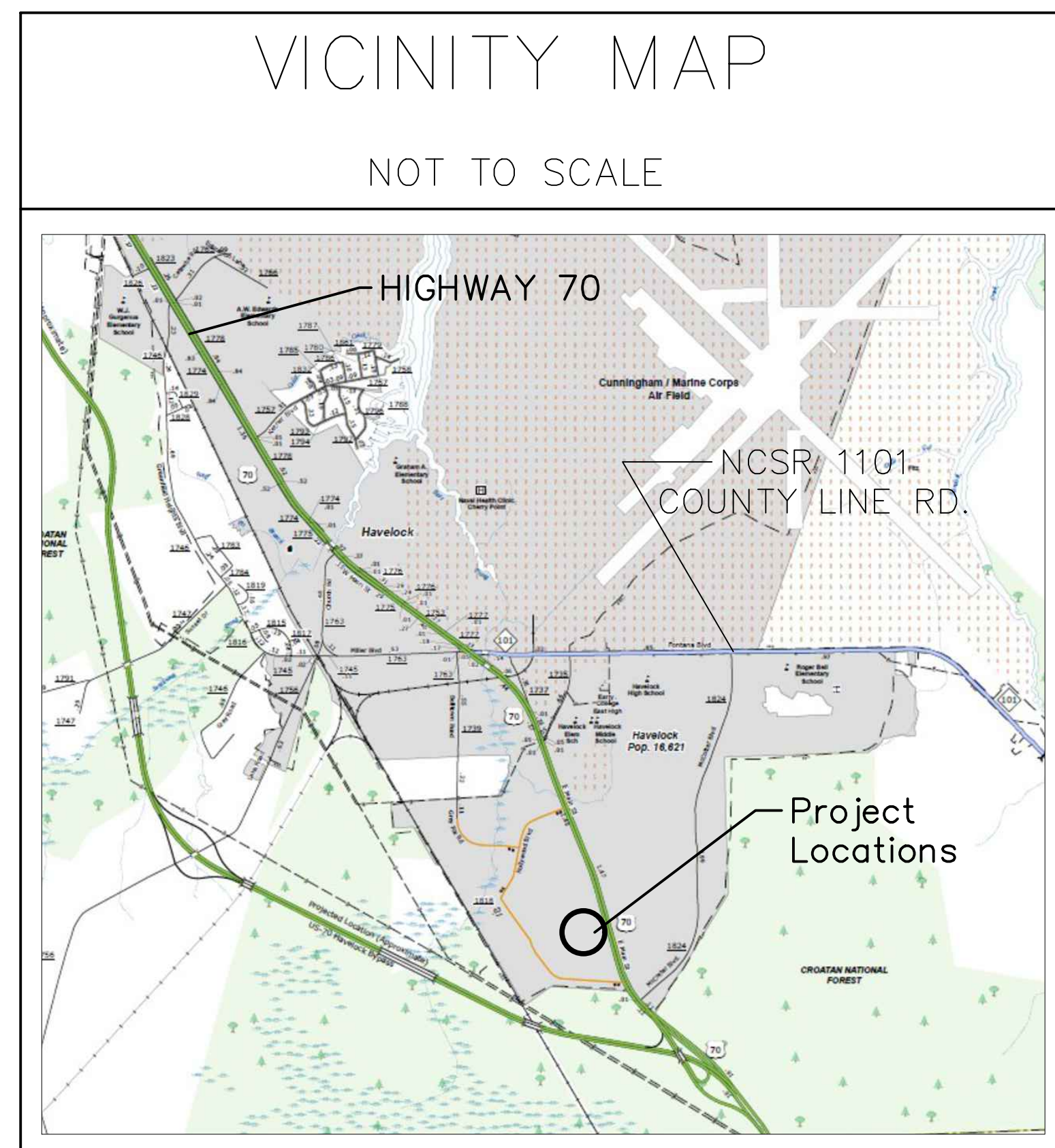

OWNER

CRAVEN COUNTY
 406 CRAVEN STREET
 NEW BERN, NORTH CAROLINA 28560



NOTES

- CURRENT ZONING: HC
 NO WETLANDS OR STREAM EVALUATION WAS PERFORMED BY THE OWNER/DEVELOPER. EVALUATION OF WETLANDS AND STREAM LOCATION ARE BASED ON PRIOR SURVEY PLATS AND NATIONAL WETLAND INVENTORY MAP. NO WETLAND OR STREAM AREAS ARE LOCATED WITHIN THE PROJECT LIMITS OF DISTURBANCE. WETLANDS ARE LOCATED OUTSIDE OF THE LIMITS OF DISTURBANCE.
 HOURS OF OPERATION: DAWN TO DUSK

GENERAL NOTES:

1. THE GENERAL CONTRACTOR (G.C.) IS RESPONSIBLE FOR VERIFYING THAT ALL APPLICABLE PERMITS AND APPROVALS HAVE BEEN OBTAINED PRIOR TO ANY WORK. THIS INCLUDES APPROVALS AND/OR PERMITS FOR WORK DONE IN PUBLIC RIGHTS-OF-WAY, PRIVATE PROPERTY OR PRIVATE/PUBLIC EASEMENTS.
2. G.C. TO VISIT SITE AND ACCEPT THE SITE CONDITIONS AFTER REVIEWING SITE WORK CONSTRUCTION DOCUMENTS AND PRIOR TO BIDDING, DEMOLITION, OR CONSTRUCTION.
3. G.C. IS RESPONSIBLE FOR CHECKING ALL DIMENSIONS AND "VERIFY" DIMENSIONS NOTED ON PLANS. ANY DISCREPANCIES SHALL BE REPORTED TO THE ENGINEER AND/OR OWNER'S REPRESENTATIVE IN WRITING PRIOR TO ANY FURTHER CONSTRUCTION.
4. G.C. IS RESPONSIBLE FOR LOCATING & AVOIDING ALL EXISTING UNDERGROUND UTILITIES. CONTACT NC ONE CALL SERVICE 1-800-632-4949 OR OTHER APPROPRIATE UTILITY LOCATION SERVICES FOR LOCATION AND IDENTIFICATION PRIOR TO ANY WORK.
5. G.C. TO VERIFY PROPER COVER OVER ALL EXISTING & PROPOSED UTILITIES & OTHER UNDERGROUND STRUCTURES.
6. G.C. IS RESPONSIBLE FOR KEEPING ALL PLANTING AREAS FREE OF CONSTRUCTION DEBRIS, STONES, CONCRETE, ETC.
7. THE PROPOSED UTILITY CONSTRUCTION SHALL MEET THE APPLICABLE REQUIREMENTS OF THE NC DEPARTMENT OF TRANSPORTATION'S "STANDARD SPECIFICATIONS FOR ROADS AND STRUCTURES" DATED JANUARY 2024 OR LATEST EDITION AND CITY OF NEW BERN WATER & SEWER DESIGN STANDARDS AND SPECIFICATIONS.
8. ALL WATER LINES TO BE INSTALLED WITHIN COMPLIANCE OF THE RULES AND REGULATIONS OF THE NORTH CAROLINA DEPARTMENT OF ENVIRONMENTAL QUALITY, DIVISION OF WATER RESOURCES, PUBLIC WATER SUPPLY SECTION.
9. PROVIDE ACCESS FOR THE OWNER'S REPRESENTATIVES TO ALL PHASES OF CONSTRUCTION. NOTIFY THE UTILITY OWNER TWO WEEKS PRIOR TO COMMENCEMENT OF ANY WORK AND ONE WEEK PRIOR TO SERVICE INTERRUPTION. KEEP UTILITY OWNERS' REPRESENTATIVES INFORMED OF WORK PROGRESS AND PROVIDE OPPORTUNITY FOR INSPECTION OF CONSTRUCTION AND TESTING.
10. THE PLANS DEPICT THE BEST AVAILABLE INFORMATION FOR THE LOCATION, SIZE, AND TYPE OF MATERIAL FOR ALL EXISTING UTILITIES. MAKE INVESTIGATIONS FOR DETERMINING THE EXACT LOCATION, SIZE, AND TYPE OF MATERIAL FOR THE EXISTING FACILITIES AS NECESSARY FOR THE CONSTRUCTION OF THE PROPOSED UTILITIES AND FOR AVOIDING DAMAGE TO EXISTING FACILITIES. REPAIR ANY DAMAGE INCURRED TO EXISTING FACILITIES TO THE ORIGINAL OR BETTER CONDITION AT NO ADDITIONAL COST TO THE OWNER.
11. MAKE CONNECTIONS BETWEEN EXISTING AND PROPOSED UTILITIES AT TIMES MOST CONVENIENT TO THE PUBLIC, WITHOUT ENDANGERING THE UTILITY SERVICE, AND IN ACCORDANCE WITH THE UTILITY OWNER'S REQUIREMENTS. MAKE CONNECTIONS ON WEEKENDS, AT NIGHT, OR ON HOLIDAYS IF NECESSARY.
12. CONTRACTOR SHALL HAVE IN THEIR POSSESSION A COMPLETE SET OF CONTRACT DOCUMENTS, PERMITS AND EASEMENTS.
13. ALL SHOP DRAWINGS MUST BE REVIEWED AND APPROVED BY OWNER AND ENGINEER.
14. CONTRACTOR SHALL MAKE EVERY EFFORT TO SAVE PROPERTY IRONS, MONUMENTS, OTHER PERMANENT POINTS AND LINES OF REFERENCE AND CONSTRUCTION STAKES.
15. CONTRACTOR SHALL BE RESPONSIBLE FOR MAINTAINING TRAFFIC FLOW DURING THE COURSE OF CONSTRUCTION.

PROJECT SPECIFIC NOTES:

1. CONTRACTOR TO ENSURE THAT THERE IS A POSITIVE DRAINAGE ACROSS ALL NEW ASPHALT, CONCRETE AND GRAVEL SURFACES.
2. CONTRACTOR SHALL PROVIDE A NEAT AND SMOOTH TRANSITIONS IN ALL AREAS WHERE NEW PAVEMENT AND EXISTING PAVEMENT TIE TOGETHER.
3. CONTRACTOR SHALL ADJUST ALL UTILITY TOPS (VALE BOX, METER BOX, MANHOLES, ETC.) TO BE FLUSH WITH PROPOSED FINISHED GRADE.
4. WATER LINE CONSTRUCTION SHALL BE IN ACCORDANCE WITH NCDEQ AND THE CITY OF NEW BERN WATER AND SEWER DESIGN STANDARDS ALONG WITH THE PROJECT SPECIAL PROVISIONS.
5. THE CITY OF NEW BERN SHALL BE NOTIFIED A MINIMUM OF 48 HOURS PRIOR TO THE BEGINNING OF WATER WORK.
6. CRAVEN COUNTY SHALL BE NOTIFIED A MINIMUM OF 48 HOURS PRIOR TO THE BEGINNING OF WATER WORK.
7. THE CITY OF NEW BERN MAY HAVE A REPRESENTATIVE ON SITE DURING ALL WATER LINE CONSTRUCTION ACTIVITIES.
8. SERVICE INTERRUPTION SHALL NOT EXCEED 8 HOURS.
9. ALL NCDEQ AND LOCAL TESTING MUST BE COMPLETED AND APPROVED PRIOR TO CONNECTING THE NEW CONSTRUCTION TO THE EXISTING WATER LINES.
10. ALL WORK SHALL CONFORM TO THE CITY OF NEW BERN'S WATER & SEWER DESIGN STANDARDS DATED JULY 2023.
11. CONTRACTOR SHALL REMOVE ANY UNSTABLE MATERIAL AND/OR ORGANIC MATERIAL ENCOUNTERED IN UTILITY TRENCH. CONTRACTOR SHALL REPLACE WITH SUITABLE MATERIAL AND COMPACT TO 95% PROCTOR BELOW 3- FEET AND 100% PROCTOR FROM SURFACE TO 3- FEET.
12. NO CONSTRUCTION TO BE INITIATED WITHIN RIGHT-OF-WAY OF ROADS THAT ARE MAINTAINED BY NCDOT WITHOUT PRIOR APPROVAL OF NCDOT. NCDOT APPROVAL TO BE EVIDENCED BY AN APPROPRIATE ENCROACHMENT AGREEMENT AND/OR DRIVEWAY PERMIT, AS APPLICABLE. A COPY OF APPROVED ENCROACHMENT AGREEMENT AND/OR DRIVEWAY PERMIT TO BE IN CONTRACTOR POSSESSION AT JOB SITE AT ALL TIMES THAT WORK IS BEING PERFORMED. NOTIFY NCDOT DISTRICT OFFICE AND POST ANY REQUIRED INDEMNITY BOND PRIOR TO BEGINNING WORK IN NCDOT RIGHT-OF-WAY.
13. INSTALL UTILITIES WITHIN NCDOT RIGHT-OF-WAY PER POLICIES & PROCEDURES FOR ACCOMMODATING UTILITIES ON HIGHWAY RIGHTS-OF-WAY, LATEST REVISION, AS PUBLISHED BY NCDOT, DIVISION OF HIGHWAY, OR THOSE OF CITY, WHICHEVER IS MORE STRINGENT.
14. CONTRACTOR TO PROVIDE GUARANTEE ON WORKMANSHIP AND MATERIALS FOR A PERIOD OF 1 YEAR AFTER DATE OF ACCEPTANCE BY CITY OF NEW BERN. ANY DEFECTS OBSERVED WITHIN THE 1 YEAR GUARANTEE PERIOD IS TO BE REPAIRED AND/OR REPLACED TO CITY'S SATISFACTION AND THE COST OF SUCH REPAIRS ARE TO BE BORNE BY THE CONTRACTOR.
15. ALL WATER SERVICE LINES SHALL BE LAID WITH DETECTABLE TAPE AND TRACER WIRE, AS INDICATED IN DETAILS AND SECTION 3.2.9 OF THE "CITY OF NEW BERN'S WATER AND SEWER DESIGN STANDARDS." TRACER WIRE SHALL BE 12 GAUGE, SINGLE STRAND COPPER WIRE, HDPE COATED AND WATERPROOF AS PER SECTION 5.13 OF THE CITY'S WATER AND SEWER DESIGN STANDARDS.

	Description	Date
REVISIONS		

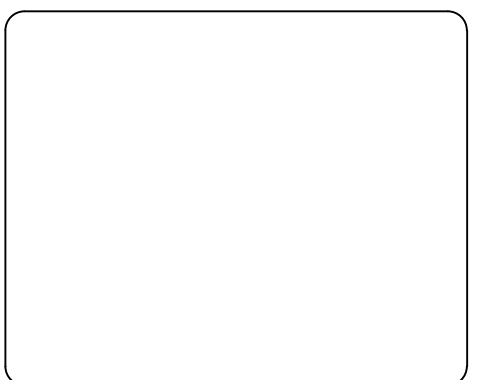
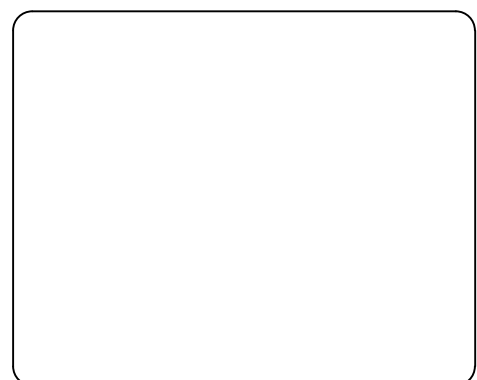



CRAVEN COUNTY

406 CRAVEN STREET
NEW BERN, NC 28560
(252) 636-6600

1712

CRAVEN COUNTY GOVERNMENT CENTER EAST

1208 E MAIN STREET, HAVELOCK, NC

GENERAL NOTES SHEET

PRELIMINARY NOT FOR CONSTRUCTION

PROJ. START DATE: 6/22/2026 CC PROJ. # 2026-FA-001 DRAWN JWD DESIGNED DHA CHECKED JWD PROJ. MGR DHA	Sheet Title HORIZONTAL N/A VERTICAL N/A	C - 3 DRAWING NUMBER 0 REVISION
STATUS: PRELIMINARY NOT FOR CONSTRUCTION		

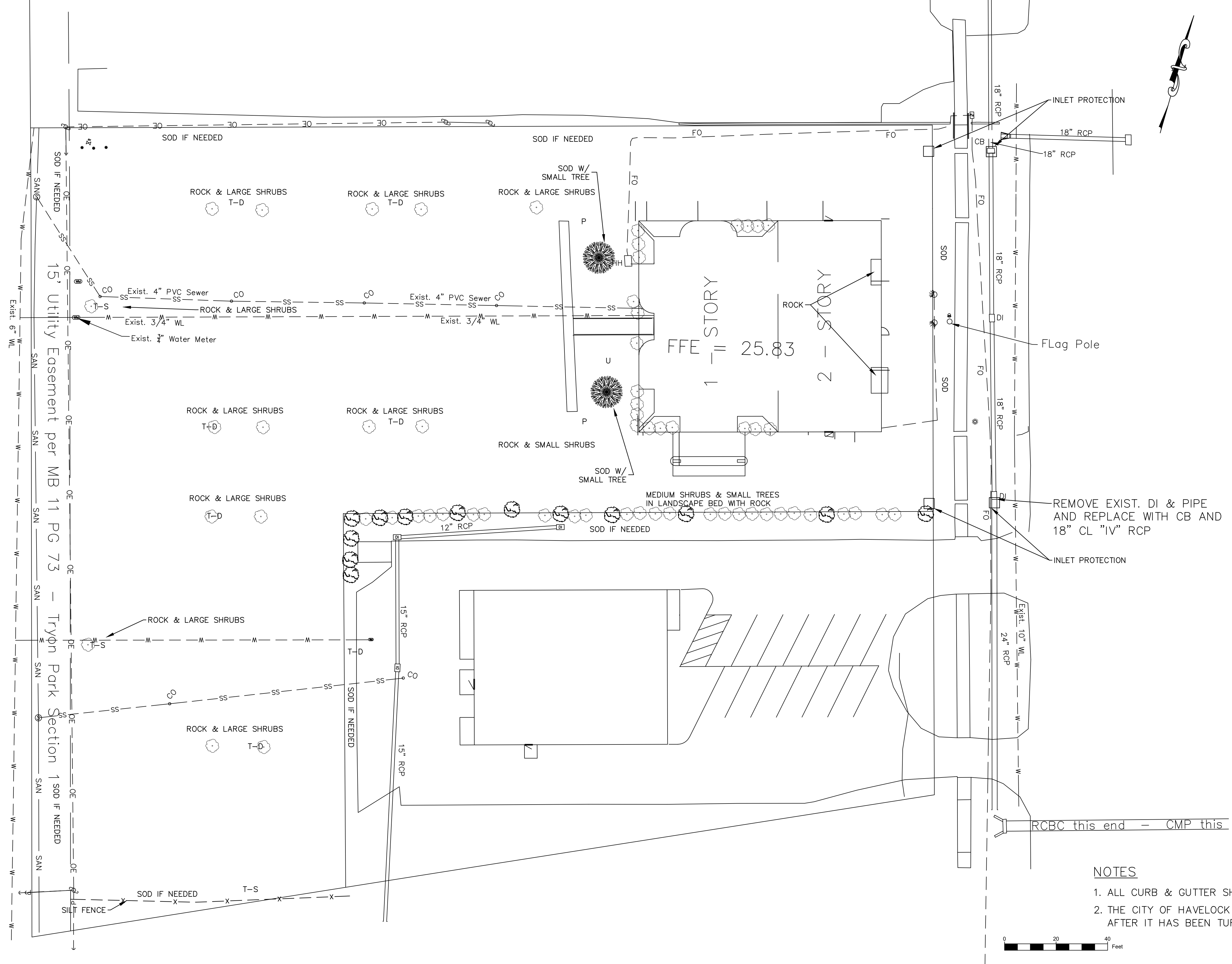

NOTES

- 1. ALL CURB & GUTTER SHALL BE REMOVED.
- 2. THE CITY OF HAVELOCK WILL REMOVE THE 3/4" METER AFTER IT HAS BEEN TURNED OFF AT THE TAP.



Description	Date

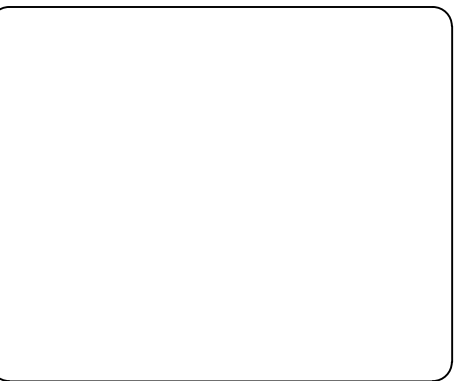

CrAVEN COUNTY
 406 CrAVEN STREET
 NEW BERN, NC 28560
 (252) 636-6600

CrAVEN COUNTY GOVERNMENT CENTER EAST
 1208 E MAIN STREET, HAVELOCK, NC
 DEMO PLAN SHEET
 PRELIMINARY NOT FOR CONSTRUCTION

PROJ. START DATE:	6/22/2026
CC PROJ. #	2026-FA-001
DRAWN	JWD
DESIGNED	DHA
CHECKED	JWD
PROJ. MGR	DHA

Sheet Title	HORIZONTAL
	1" = 20'
VERTICAL	N/A

C - 5
DRAWING NUMBER
0
REVISION

PRELIMINARY NOT FOR CONSTRUCTION

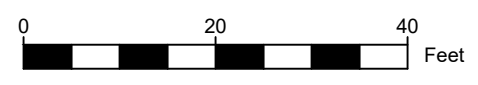
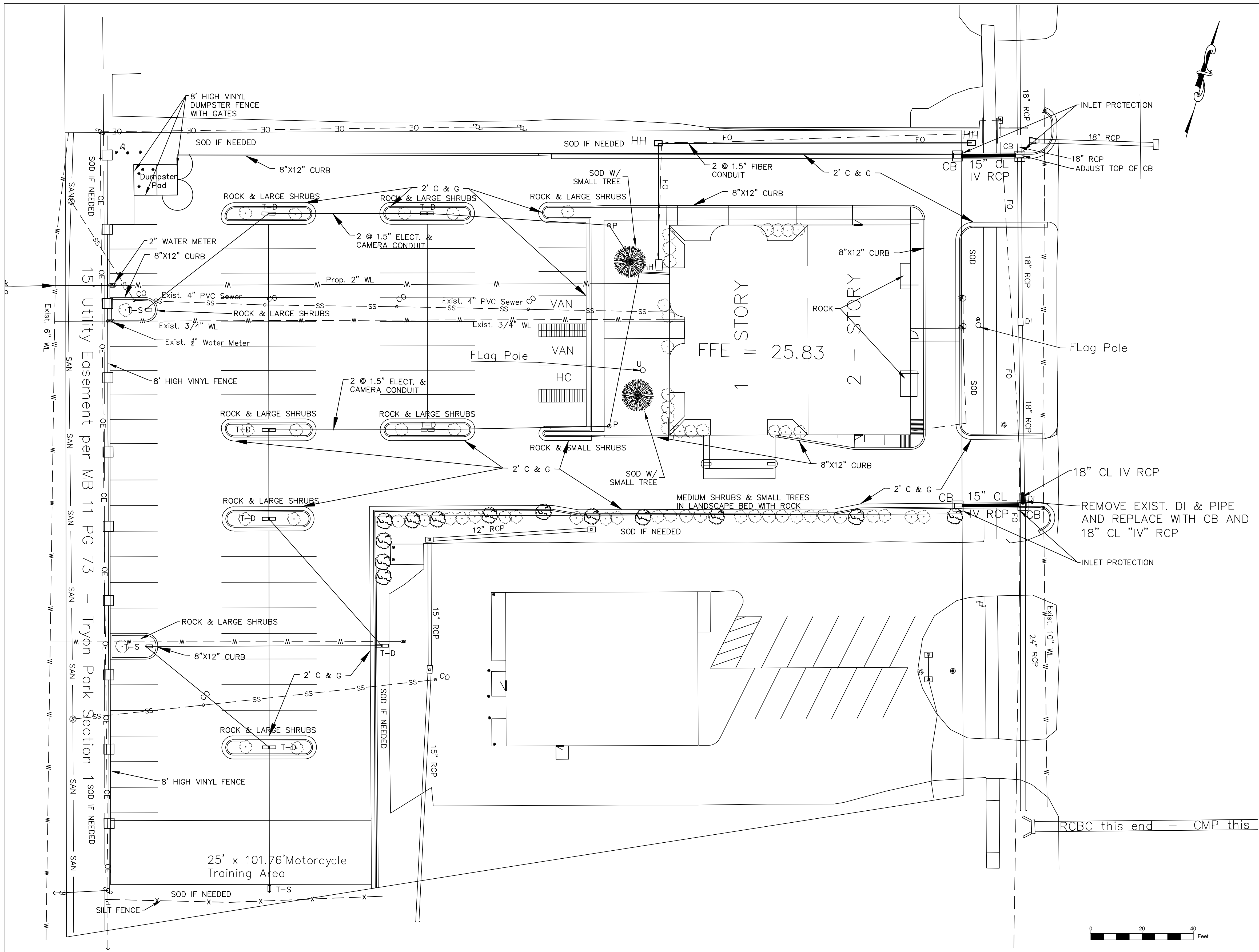

Description	Date

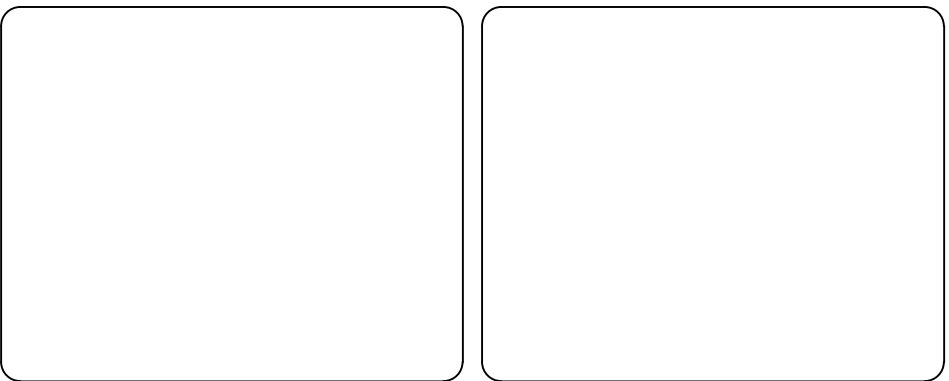

Craven County
 406 Craven Street
 New Bern, NC 28560
 (252) 636-6600

Craven County Government Center East
 1208 E Main Street, Havelock, NC
 Erosion and Sediment Control Plan Sheet
 Preliminary Not for Construction

PROJ. START DATE: 06/22/2026	Sheet Title HORIZONTAL	CES - 1
CC PROJ. # 2026-FA-00		
DRAWN: JWD	1" = 20'	DRAWING NUMBER: 0
DESIGNED: DHA	VERTICAL	REVISION:
CHECKED: JWD	N/A	
PROJ. MGR: DHA		
PRELIMINARY NOT FOR CONSTRUCTION		

